

# The Plaza at Park 51

10635 PARK ROAD, CHARLOTTE, NC 28210



**Retail**

**FOR**

| Lease

**SIZE**

| 6,719 SF

**PRICE**

| Call



## Overview

Strategically located directly across from Atrium Health's Pineville medical campus, 235 beds on ±46 acre campus offering a range of services 24/7

Redevelopment of 58,483 SF medical office and retail building, anchored by Tryon Medical Partners (25,148 SF), targeting Q4 2023

Located directly off I-485 (154,000 ADT) at Hwy 51/Pineville-Matthews Rd (55,000 ADT) and Park Road (26,000 ADT)

Shared with recently developed Aldi and Cookout with access from Hwy 51/Pineville-Matthews and Park Rd

## Retail, Medical, & Office Spaces Available For Lease in Redevelopment Building



**Robbie Adams**  
Director of Retail

(704) 248 2108  
radams@mpvre.com

**Amy Owen**  
Broker

(704) 650 0006  
amy@conistongroup.com



2400 South Boulevard | Suite 300  
Charlotte, NC 28203

[mpvre.com](http://mpvre.com)

# The Plaza at Park 51

10635 PARK ROAD, CHARLOTTE, NC 28210

## Property Overview

### Demographics

Source: Esri® 2023

	1 mile	3 mile	5 mile
Population	10,007	72,362	197,786
Avg. HH Income	\$108,005	\$124,688	\$138,554
Growth Rate	2.80%	2.77%	2.67%

### Traffic Count

Source: NCDOT

	AADT
Hwy 51 & Pineville-Matthews Rd	55,000 (2023)
Park Rd	26,000 (2023)

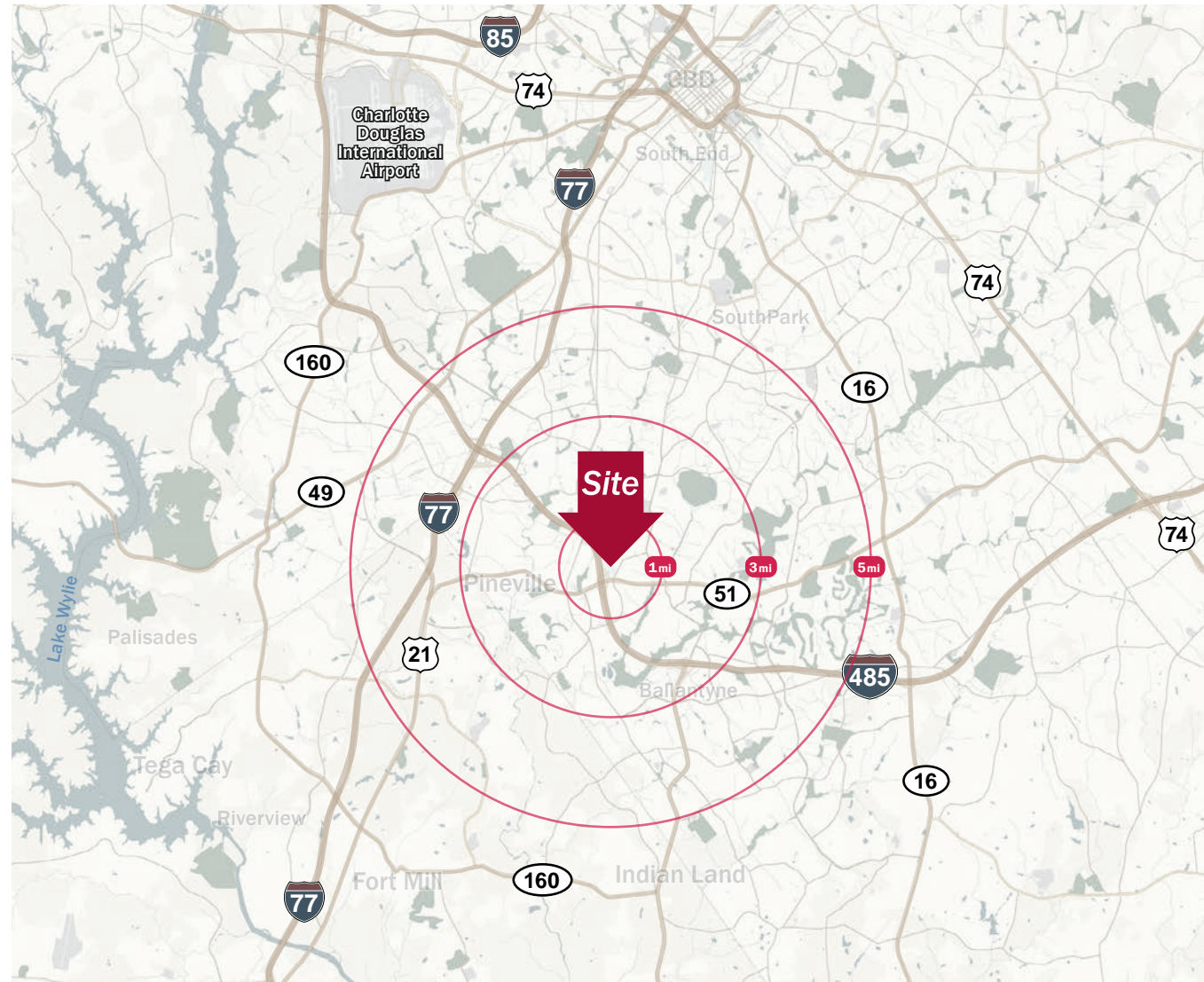

**Robbie Adams**  
Director of Retail  
(704) 248 2108  
radams@mpvre.com

**Amy Owen**  
Broker



(704) 650 0006  
amy@conistongroup.com

2400 South Boulevard | Suite 300  
Charlotte, NC 28203

[mpvre.com](http://mpvre.com)

# The Plaza at Park 51

10635 PARK ROAD, CHARLOTTE, NC 28210

## Market Aerial

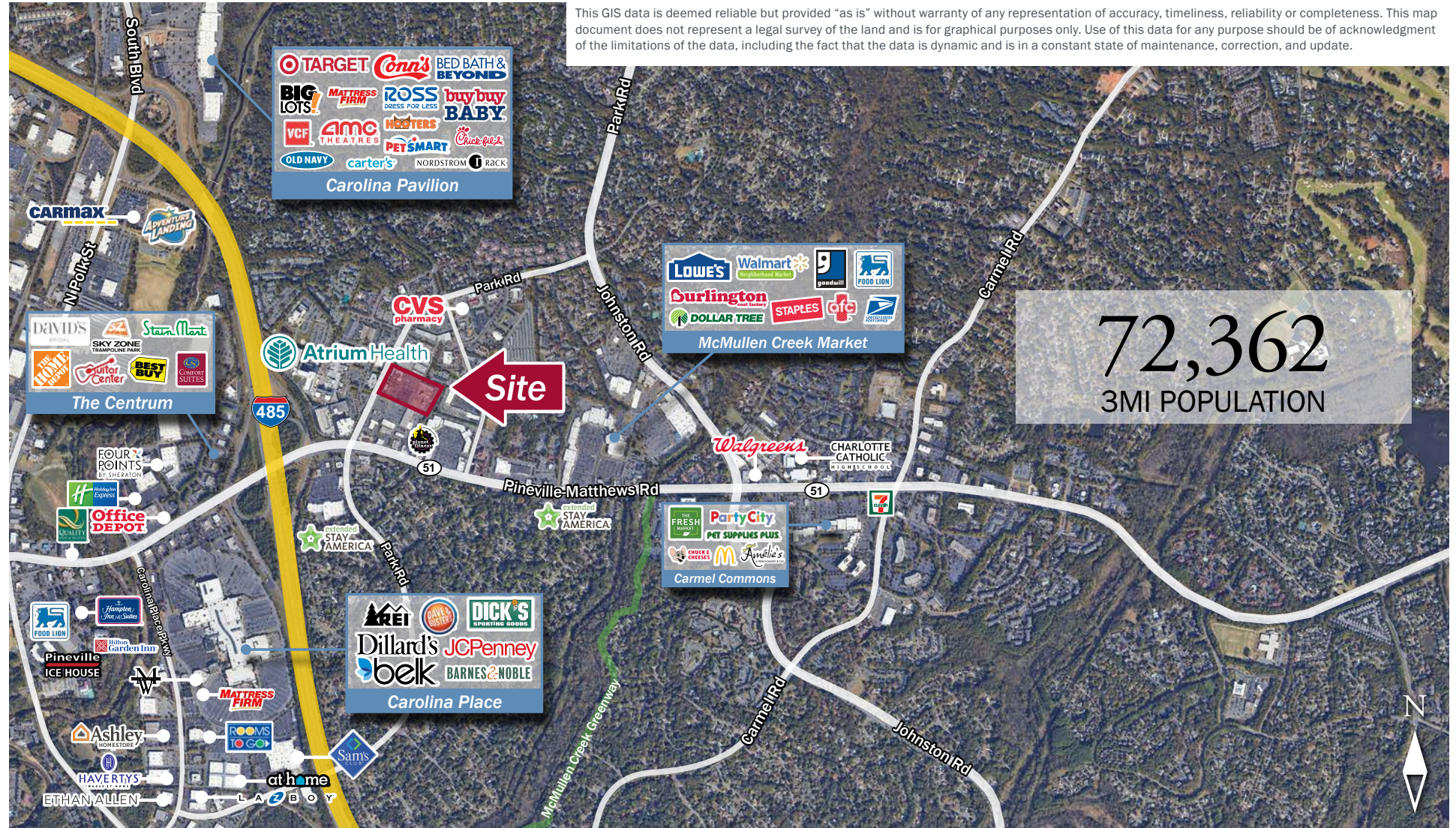

**Robbie Adams**  
Director of Retail  
(704) 248 2108  
radams@mpvre.com

**Amy Owen**  
Broker  
(704) 650 0006  
amy@conistongroup.com



2400 South Boulevard | Suite 300  
Charlotte, NC 28203

[mpvre.com](http://mpvre.com)

# The Plaza at Park 51

10635 PARK ROAD, CHARLOTTE, NC 28210

## Site Plan Overlay

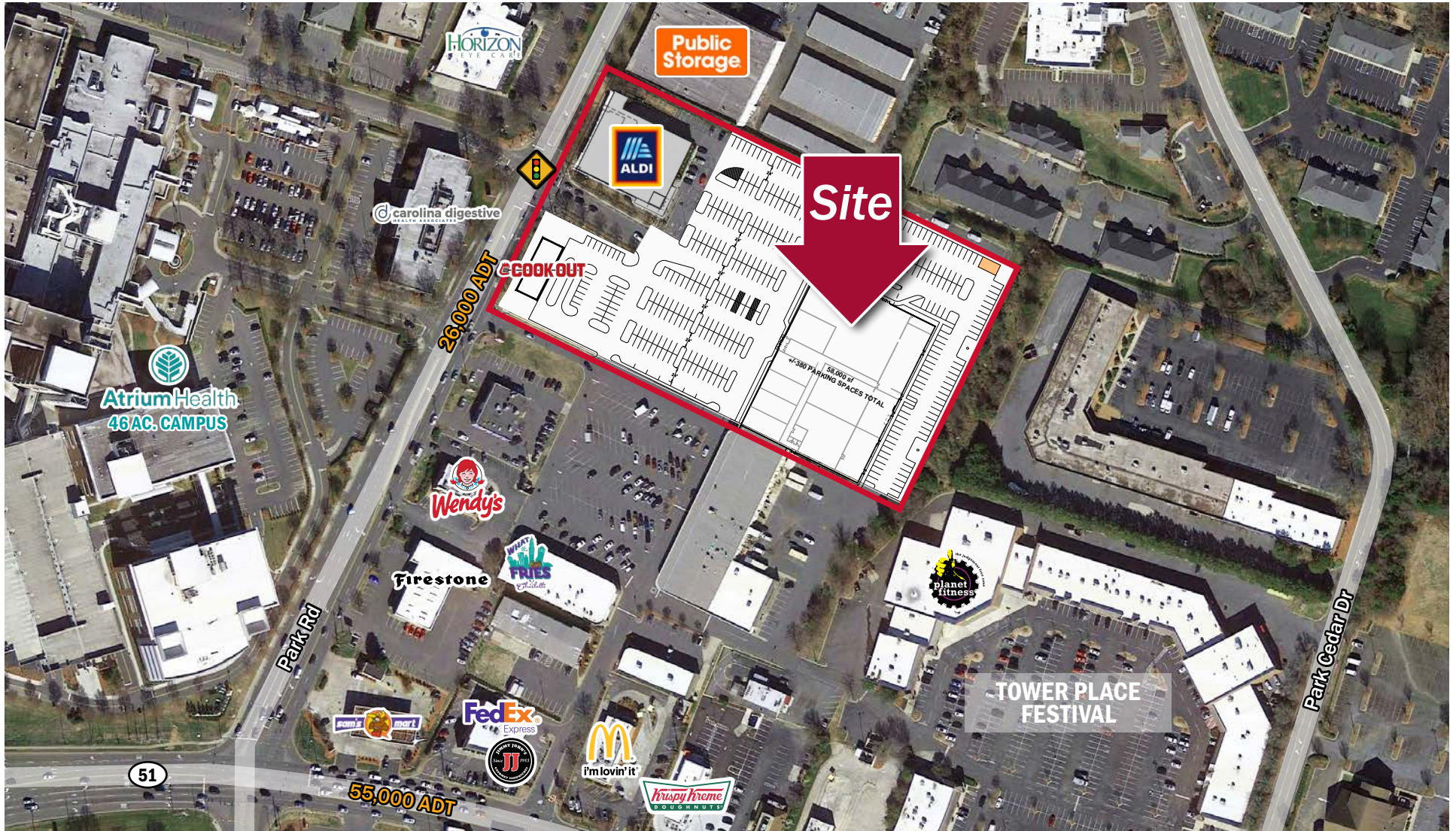

Robbie Adams  
Director of Retail  
(704) 248 2108  
radams@mpvre.com

Amy Owen  
Broker



(704) 650 0006  
amy@conistongroup.com

2400 South Boulevard | Suite 300  
Charlotte, NC 28203

mpvre.com

# The Plaza at Park 51

10635 PARK ROAD, CHARLOTTE, NC 28210

## Floor Plan

Suite	Total RSF	Availability
A	3,349 RSF	Available
B	2,500 RSF	Leased <i>Pineville Dental Studio</i>
C	2,178 RSF	Leased <i>Queens Pharmacy</i>
D	2,178 RSF	Leased <i>Ivy Rehab</i>
E	3,370 RSF	Available
F	9,434 RSF	Leased <i>Oncology Specialists of Charlotte PA</i>
G & H	10,665 RSF	Leased <i>Gracious Living</i>
I	24,760 RSF	Leased <i>Tryon Medical Partners</i>

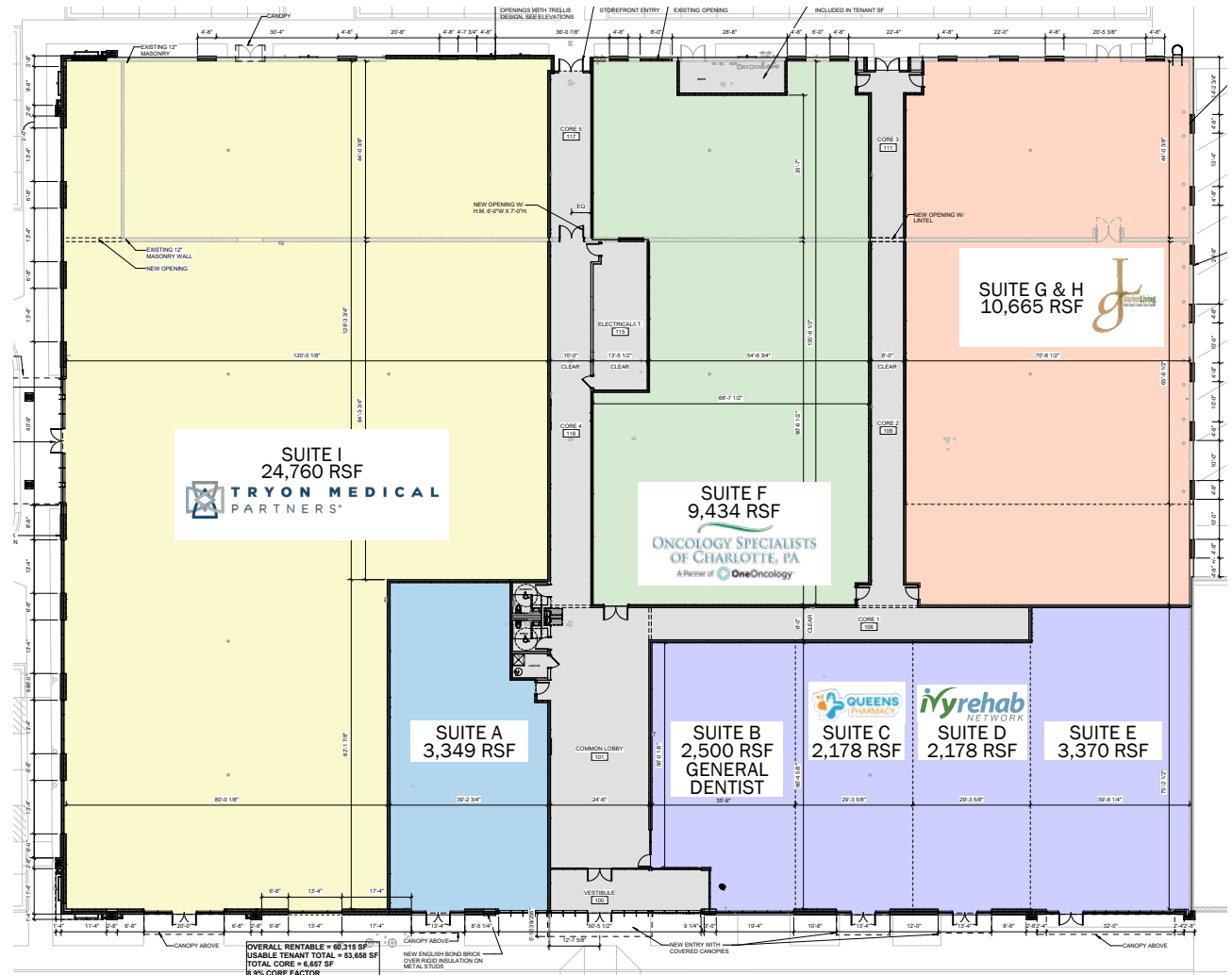

**Robbie Adams**  
 Director of Retail  
 (704) 248 2108  
 radams@mpvre.com

**Amy Owen**  
 Broker



(704) 650 0006  
 amy@conistongroup.com

2400 South Boulevard | Suite 300  
 Charlotte, NC 28203

mpvre.com

# The Plaza at Park 51

10635 PARK ROAD, CHARLOTTE, NC 28210

## Property Photos



**Robbie Adams**  
Director of Retail  
(704) 248 2108  
radams@mpvre.com

**Amy Owen**  
Broker



(704) 650 0006  
amy@conistongroup.com

2400 South Boulevard | Suite 300  
Charlotte, NC 28203

[mpvre.com](http://mpvre.com)

# The Plaza at Park 51

10635 PARK ROAD, CHARLOTTE, NC 28210

## Site Photos



**Robbie Adams**  
Director of Retail  
(704) 248 2108  
radams@mpvre.com

**Amy Owen**  
Broker



(704) 650 0006  
amy@conistongroup.com

2400 South Boulevard | Suite 300  
Charlotte, NC 28203

[mpvre.com](http://mpvre.com)

# The Plaza at Park 51

10635 PARK ROAD, CHARLOTTE, NC 28210

## Site Photos



**Robbie Adams**  
Director of Retail  
(704) 248 2108  
radams@mpvre.com

**Amy Owen**  
Broker



(704) 650 0006  
amy@conistongroup.com

2400 South Boulevard | Suite 300  
Charlotte, NC 28203

[mpvre.com](http://mpvre.com)





Working Together

Medical | Industrial | Retail | Land | Investment | Office

contact

**Robbie Adams**  
*Director of Retail*

(704) 248 2108  
radams@mpvre.com

**Amy Owen**  
*Broker*

(704) 650 0006  
amy@conistongroup.com



2400 South Boulevard | Suite 300  
Charlotte, NC 28203

[mpvre.com](http://mpvre.com)